

FLOOR PLANS - WILLOW



Main Floor: 690 sq ft

Upper Floor: 640 sq ft

Basement: 690 sq ft

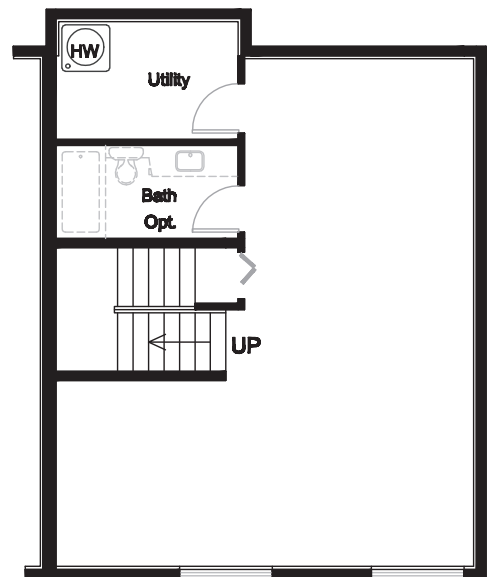
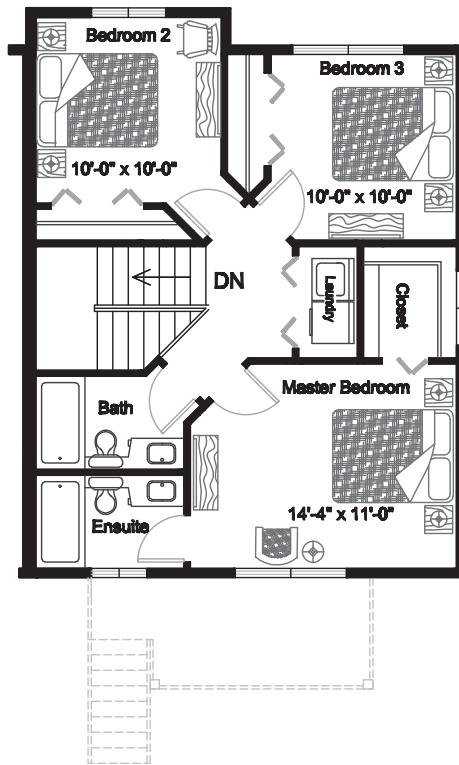
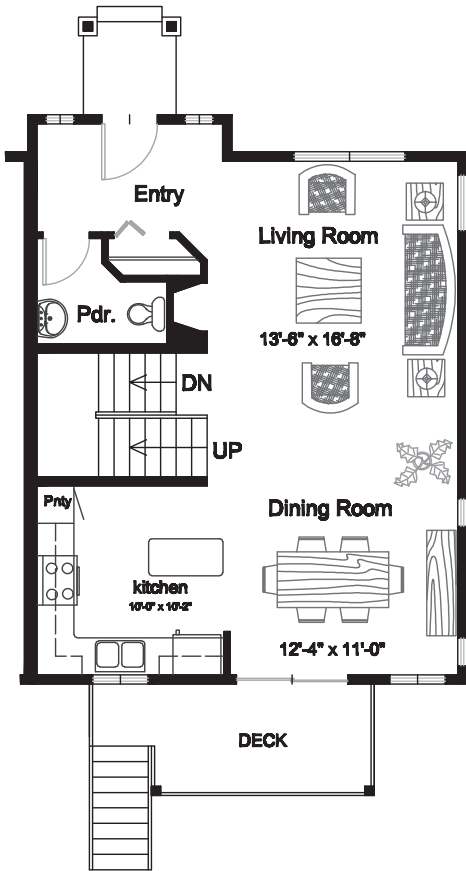

Total: 2020 sq ft

SHIRLEY ZAILO &
RYAN ZAILO
RE/MAX CAMOSUN

101-791 Goldstream Ave
Victoria, BC, V9B 2X5
Phone: 250.478.4828
Fax: 250.478.6060

WWW.ARTISANPARK.CA



ARTISAN PARK
A NEIGHBOURHOOD OF NEW HOMES